



CK1107

走心式数控车床
Spindle Movable Type CNC machine



机器概述 Description of CK-1107

CK1107走心式数控车床，在设计上具有，结构合理、换刀快捷、可靠性高的特点。走心机在加工较细长零件时，和同类机床相比，可以明显减少送料次数，提高加工效率。对于许多长度在150mm以内的零件，可以一次送料完成零件全长度的加工。

走心机的送料部分可以配备自动送料器，接料部分可安装短件接料器及长件接料器（需订制），以实现一人操作、看护多台机床的“一人多机”加工模式，为工厂节省人力资源。

该类走心机最适合加工用于汽摩配、医疗、微型轴、电子接插件、气动工具、钟表等行业的各种高精度、多批量、外形复杂的轴类零件的精密复合加工。

CK1107 Spindle Movable Type CNC machine has features of reasonable structure, fast tool changing, high reliability. The machine, compared with all others of its class, can obviously reduce times of feeding material, and improve efficiency when processing slender parts. A one-time material feeding is enough for processing full length of parts that less than 150mm.

The material feeding part of the machine is equipped with automatic feeder, and the catching part can be installed with short and long part catching device (can order according to your need) to realize the processing mode that one person minds several machines, so as to save labour.

This kind of machine is the best for processing shaft parts that have complicated shape and require high precision and mass production in car and motor accessory, medicine, micro-axis, electronic component, pneumatic tool, clock industries etc.

细节特写 Details



机器特点 Machine Features

- 可选配旋转导套，加工六角、方形等型材，
- 刀具数量多，刀具交换快速
- 能加工超细长的各种零件
- Equip with optional rotating guide bush, and can processing hexagonal, square etc section.
- Large number of tools with fast changing speed.
- Can process very slender parts.

技术参数 Main Technical Parameters

机床型号 Model	规格项目 Specification	Ck1107
电源 Power	电源额定电压 Rated Voltage	3相交流电，380V Three Phase AC Current
	电源额定频率 Rated Frequency	50HZ
	总输入功率 Total Input Power	3KW
数控系统 CNC System		YZ150
	最小设定单位 Min Setting Value	0.001MM
	X轴脉冲当量 X Axis Pulse Equivalent	0.0005MM
	Y轴脉冲当量 Y Axis Pulse Equivalent	0.001MM
	Z轴脉冲当量 Z Axis Pulse Equivalent	0.001MM
	最大编程尺寸 Max Programming size	±9999.999MM
	切削速度 Cutting Speed	1--4000MM/MIN
	X轴快速进给速度 X Axis Fast Feed Rate	15000MM/MIN
	Y轴快速进给速度 Y Axis Fast Feed Rate	15000MM/MIN
	Z轴快速进给速度 Z Axis Fast Feed Rate	15000MM/MIN
主轴 Spindle	最大棒材直径 Max Bar Diameter	Ø7MM
	主轴通孔直径 Spindle Hole Diameter	Ø8MM
	主轴中心离地面高度 The height of spindle center from ground	980MM
	主轴转速 Rotating Speed	50-6000R/MIN
	主轴马达功率 Power	1.5KW
	行程 Stroke	X轴行程 X Axis Stroke
Y轴行程 Y Axis Stroke		150MM
Z轴行程 Z Axis Stroke		150MM
X轴伺服马达功率 X Axis Servo Motor Power		0.4KW
Y轴伺服马达功率 Y Axis Servo Motor Power		0.4KW
Z轴伺服马达功率 Z Axis Servo Motor Power		0.4KW
	滑轨形式 Slide guide mode	直线导轨 Linear Guide Rail

外型图 Outline Drawing

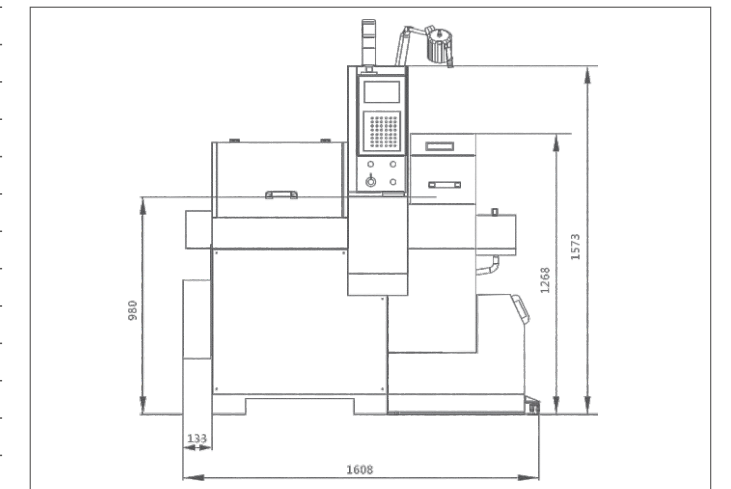

排刀系统 Tool System	排刀式 Gang Tool	共8把 8tools
	车削刀具 Turning Tool	8把 8tools
	刀具尺寸 Tool Size	□8*8mm
冷却系统 Cooling System	正面钻孔刀具 Obverse Side Drilling Tool	4把 4 tools
	钻孔轴尺寸 Drilling Spindle Size	ER8/12mm
	切削油用电动机功率 Cutting Motor Power	0.12kW
润滑系统 Lubricating System	冷却箱容量 Capacity of Cooling Container	120L
	马达功率 Motor Power	25W
气动系统 Pneumatic System	容量 Capacity	2L
	输入压缩空气气压 Input Pressure of Compressed Air	0.4--0.6MPa
机床尺寸 Machine Size	长*宽*高 L*W*H	1608*1100*1573
	机床重量 Weight	600kg

CK1113

走心式数控车床

Spindle Movable Type CNC machine



机器概述 Description of CK-1113

CK1113走心式数控车床，在设计上具有，结构合理、换刀快捷、可靠性高的特点。走心机在加工较细长零件时，和同类机床相比，可以明显减少送料次数，提高加工效率。对于许多长度在150mm以内的零件，可以一次送料完成零件全长度的加工。

走心机的送料部分可以配备自动送料器，接料部分可安装短件接料器及长件接料器（需订制），以实现一人操作、看护多台机床的“一人多机”加工模式，为工厂节省人力资源。

该类走心机最适合加工用于汽摩配、医疗、微型轴、电子接插件、气动工具、钟表等行业的各种高精度、多批量、外形复杂的轴类零件的精密复合加工。

CK1113 Spindle Movable Type CNC machine has features of reasonable structure, fast tool changing, high reliability. The machine, compared with all others of its class, can obviously reduce times of feeding material, and improve efficiency when processing slender parts. A one-time material feeding is enough for processing full length of parts that less than 150mm.

The material feeding part of the machine is equipped with automatic feeder, and the catching part can be installed with short and long part catching device (can order according to your need) to realize the processing mode that one person minds several machines, so as to save labour.

This kind of machine is the best for processing shaft parts that have complicated shape and require high precision and mass production in car and motor accessory, medicine, micro-axis, electronic component, pneumatic tool, clock industries etc.

细节特写 Details

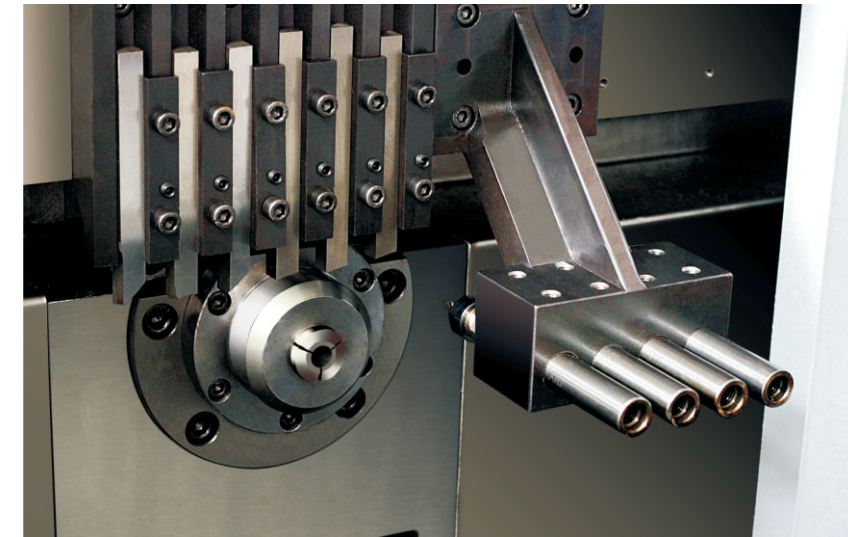

机器特点 Machine Features

- 可选配旋转导套，加工六角、方形等型材，
 - 刀具数量多，刀具交换快速
 - 能加工超细长的各种零件
- Equip with optional rotating guide bush, and can processing hexagonal, square etc section.
 - Large number of tools with fast changing speed.
 - Can process very slender parts.

技术参数 Main Technical Parameters

机床型号 Model	规格项目 Specification	Ck1113
电源 Power	电源额定电压 Rated Voltage	3相交流电，380V Three Phase AC Current
	电源额定频率 Rated Frequency	50Hz
	总输入功率 Total Input Power	4kW
数控系统 CNC System		YZ150
	最小设定单位 Min Setting Value	0.001mm
	X轴脉冲当量 X Axis Pulse Equivalent	0.0005mm
	Y轴脉冲当量 Y Axis Pulse Equivalent	0.001mm
	Z轴脉冲当量 Z Axis Pulse Equivalent	0.001mm
	最大编程尺寸 Max Programming size	±9999.999mm
	切削速度 Cutting Speed	1--4000mm/min
	X轴快速进给速度 X Axis Fast Feed Rate	15000mm/min
主轴 Spindle	Y轴快速进给速度 Y Axis Fast Feed Rate	15000mm/min
	Z轴快速进给速度 Z Axis Fast Feed Rate	15000mm/min
	最大棒材直径 Max Bar Diameter	Ø13mm
	主轴通孔直径 Spindle Hole Diameter	Ø14mm
行程 Stroke	主轴中心离地面高度 The height of spindle center from ground	980mm
	主轴转速 Rotating Speed	50-6000r/min
	主轴马达功率 Power	2kW
	X轴行程 X Axis Stroke	60mm(直径量) Diameter
	Y轴行程 Y Axis Stroke	200mm
	Z轴行程 Z Axis Stroke	150mm
排刀系统 Tool System	X轴伺服马达功率 X Axis Servo Motor Power	0.75kW
	Y轴伺服马达功率 Y Axis Servo Motor Power	0.75kW
	Z轴伺服马达功率 Z Axis Servo Motor Power	0.75kW
	滑轨形式 Slide guide mode	直线导轨 Linear Guide Rail
	排刀式 Gang Tool	共10把 10 tools
冷却系统 Cooling System	车削刀具 Turning Tool	6把 6 tools
	刀具尺寸 Tool Size	□10*10mm
	正面钻孔刀具 Obverse Side Drilling Tool	4把 4 tools
润滑系统 Lubricating System	钻孔轴尺寸 Drilling Spindle Size	ER11/16mm
	切屑油用电机功率 Cutting Motor Power	0.12kW
气动系统 Pneumatic System	冷却箱容量 Capacity of Cooling Container	120L
	马达功率 Motor Power	25W
机床尺寸 Machine Size	容量 Capacity	2L
	输入压缩空气气压 Input Pressure of Compressed Air	0.4--0.6MPa
	长*宽*高 L*W*H	1608*1100*1573
	机床重量 Weight	800kg

外型图 Outline Drawing

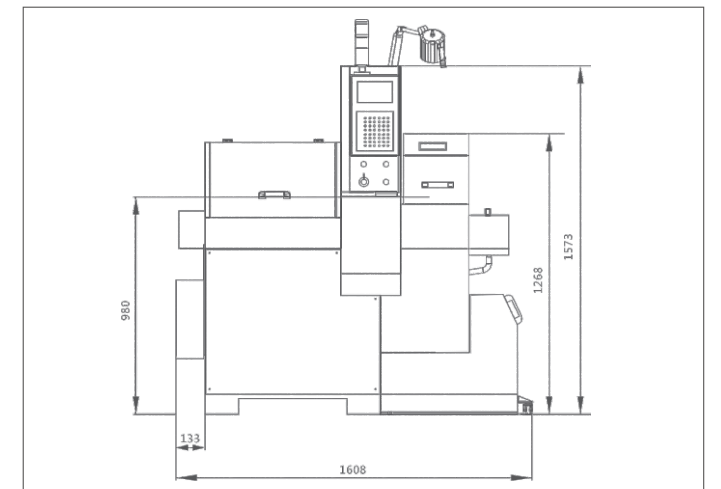

CK1120/1120C

走心式数控车床

Spindle Movable Type CNC machine



机器概述 Description of CK-1120

CK1120走心式数控车床，具有高精度、高效率的特性，其结构合理，三轴均采用直线滚动导轨，寿命长，精度高，由进口伺服电机驱动，直线式排刀结构具有快速换刀的特点，数控系统功能完善，操控简易。可选配侧面加工装置，实现钻孔、铣削工艺。特别适合形状复杂的零件批量生产，如微型元件、微型轴、电子接插件、眼镜钟表及各种五金小配件等。

CK1120 Spindle Movable Type CNC Lathes have features of high precision, high efficiency, and reasonable structure. The machine is equipped with three-axis linear motion guide that have long working life and high precision, and driven by high-end servo motor. The linear multiple cutter makes machine have fast tool changing speed, and functional CNC system make it easy to control. CK1120 can equip with side processing devices to make drilling and milling process. The machine is particularly suitable for mass production of complex shape parts, such as micro components, micro shaft, electronic connectors, glasses, clocks, various hardware fittings and so on.

技术参数 Main Technical Parameters

项目 Project	机床型号 Model	CK1120	CK1120C	
电源 Power	规格项目 Specification	参数 Parameter	参数 Parameter	
	电源额定电压 Rated Voltage	3相交流电, 380V Three Phase AC Current	3相交流电, 380V Three Phase AC Current	
	电源额定频率 Rated Frequency	50Hz	50Hz	
	总输入功率 Total Input Power	4.75kW	5.5kW	
数控系统 CNC System	最小设定单位 Min Setting Value	0.001mm	0.001mm	
	X轴脉冲当量 X Axis Pulse Equivalent	0.0005mm	0.0005mm	
	Y轴脉冲当量 Y Axis Pulse Equivalent	0.001mm	0.001mm	
	Z轴脉冲当量 Z Axis Pulse Equivalent	0.001mm	0.001mm	
	最大编程尺寸 Max Programming size	±9999.999mm	±9999.999mm	
	切削速度 Cutting Speed	1--4000mm/min	1--4000mm/min	
	X轴快速进给速度 X Axis Fast Feed Rate	18000mm/min	18000mm/min	
	Y轴快速进给速度 Y Axis Fast Feed Rate	18000mm/min	18000mm/min	
	Z轴快速进给速度 Z Axis Fast Feed Rate	18000mm/min	18000mm/min	
	主轴 Spindle	最大棒材直径 Max Bar Diameter	Ø20mm	Ø20mm
		主轴通孔直径 Spindle Hole Diameter	Ø21mm	Ø21mm
		主轴中心离地面高度 The height of spindle, center from ground	980mm	980mm
主轴转速 Rotating Speed		50-4000r/min	0-4000r/min	
主轴马达功率 Power		2.2kW	2kW	
行程 Stroke		X轴行程 X Axis Stroke	80mm(直径量) Diameter	80mm(直径量) Diameter
		Y轴行程 Y Axis Stroke	150mm	150mm
	Z轴行程 Z Axis Stroke	250mm	250mm	
	X轴伺服马达功率 X Axis Servo Motor Power	0.75kW	0.75kW	
	Y轴伺服马达功率 Y Axis Servo Motor Power	0.75kW	0.75kW	
	Z轴伺服马达功率 Z Axis Servo Motor Power	0.75kW	0.75kW	
	排刀系统 Tool System	滑轨形式 Slide guide mode	直线导轨 Linear Guide Rail	直线导轨 Linear Guide Rail
排刀式 Gang Tool		共12把 12 tools	共12把 12 tools	
车削刀具 Turning Tool		9把 9 tools	6把 6 tools	
刀具尺寸 Tool Size		□12*12mm	□12*12mm	
正面钻孔刀具 Obverse Side Drilling Tool		3把 3 tools	3把 3 tools	
钻孔轴尺寸 Drilling Spindle Size		ER11/20mm	ER11/20mm	
动力刀具 Power Cutting Tool		动力刀具数量 Number	-	3把 3 sets
	动力刀具马达功率 Motor Power	-	0.75kW	
	动力刀具转速 Rotation Speed	-	3000r/min	
	动力刀具夹头尺寸 Collet Size	-	ER11	
	动力刀具钻孔尺寸 Drilling Hole Size	-	Ø6mm	
	动力刀具攻牙尺寸 Tapping Size	-	M6	
冷却系统 Cooling System	切削油用电动机功率 Cutting Motor Power	0.12kW	0.12kW	
	冷却箱容量 Capacity of Cooling Container	150L	150L	
润滑系统 Lubricating System	马达功率 Motor Power	25W	25W	
	容量 Capacity	2L	2L	
气动系统 Pneumatic System	输入压缩空气气压 Input Pressure of Compressed Air	0.4--0.6MPa	0.4--0.6MPa	
机床尺寸 Machine Size	长*宽*高 L*W*H	1450*850*1650mm	1450*850*1650mm	
	机床重量 Weight	1000kg	1000kg	

机器特点 Machine Features

- 可以进行导套和无导套的切换，按照工件长度进行最合适的加工
- 无导套加工不要求研磨材料，可以高速、高精度加工棒材，余料最短只有30mm。
- 刀具数量多，刀具交换快速
- 选配动力头进行Y轴复合加工
- 能加工超细长的各种零件
- Able to switch with guide sleeves and none-guide sleeves, according to the length of the work pieces to process properly.
- Machine works without guide sleeve does not require abrasive material, which can process bars with high-speed and high accuracy, the residual bar only 30mm.
- Multi-tools, quick tools change
- Can equip with power head to Y-axis combined processing
- Able to process the various slender parts

细节特写 Details

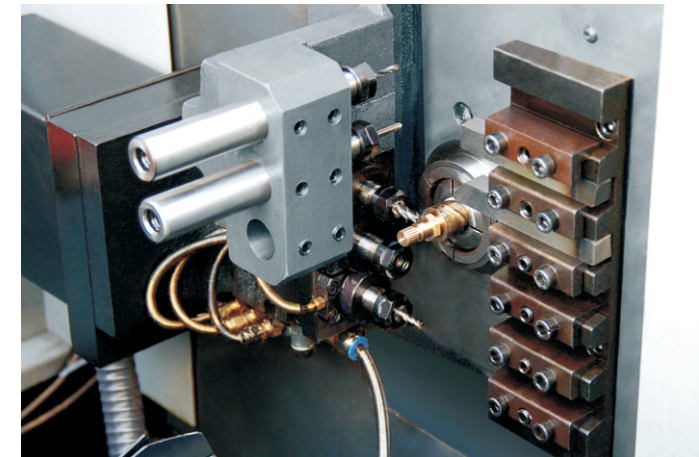

外型图 Outline Drawing

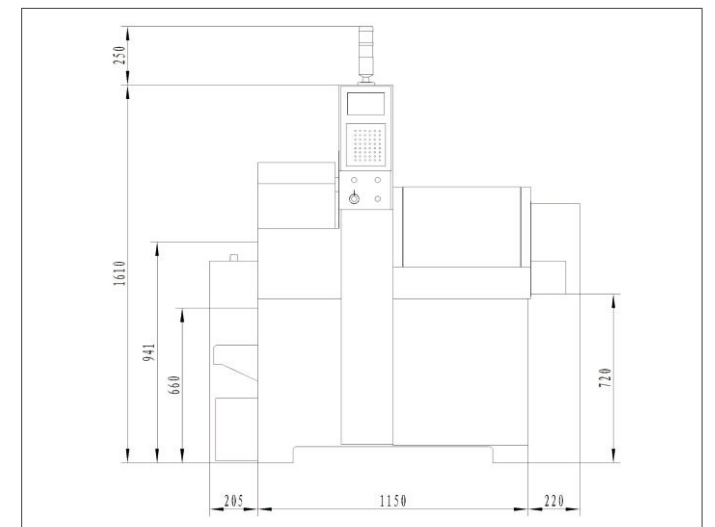

B20

双主轴走心式数控车床

B20双主轴走心式数控车床数控系统采用四轴四联动，高稳定性，高精度，操控简易。根据零件加工需要，可选配侧面动力头，实现钻孔、铣削自动化生产，结构设计稳定，高质量铸铁床身，刚性强；通过配置自动送料机，实现自动连续加工。

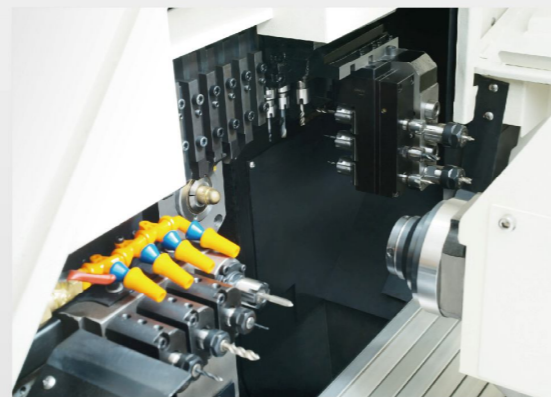

- 主/副轴标配C轴任意分度定位。
- 主轴采用进口超高精密角接触球轴承，保证主轴的高刚性和持久精度保持性，采用进口高精度丝杠轴承，采用德国力士乐高精度导轨。



18

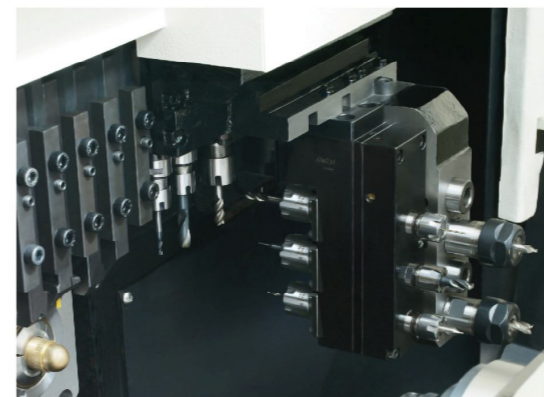

- 刀排结构采用了阶梯式导轨构造，提高刀架刚性，排屑顺畅，配置有侧面动力刀具和主轴分度功能，可以满足复杂的车、铣、钻复合加工的需求。

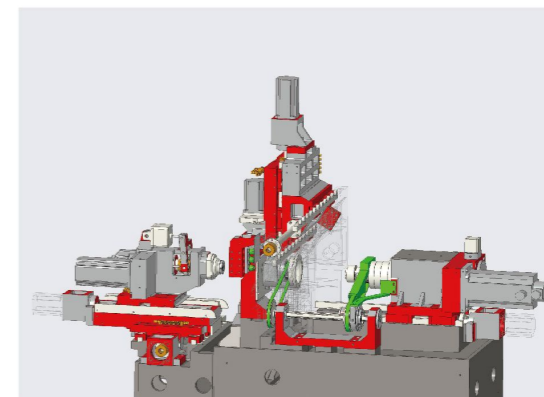

- 导套结构可选择固定导套切削，无导套切削和全程型回转导套切削方式，满足多样化的加工要求。

B20 机床参数

电源	总输入功率	18kW	行程	X轴行程	140mm (直径量)
	宝元(LNC)	6800B		Y轴行程	300mm
数控系统	最小设定单位	0.001mm	Z轴行程	300mm	
	X轴脉冲当量	0.0005mm	X轴伺服马达功率	1kW	
	Z轴脉冲当量	0.001mm	Y轴伺服马达功率	1kW	
	切削速度	1~4000mm/min	Z轴伺服马达功率	1kW	
	X轴快速进给速度	20000mm/min	滑轨形式	直线导轨	
	Y轴快速进给速度	20000mm/min	X1轴行程	500mm (直径量)	
	Z轴快速进给速度	20000mm/min	Z1轴行程	200mm	
主轴	最大棒料直径	Φ20mm	X1轴伺服马达功率	1kW	
	主轴通孔直径	Φ21mm	Z1轴伺服马达功率	1kW	
	主轴中心离地面高度	1050mm	滑轨形式	直线导轨	
	电主轴/伺服主轴转速	10000/5000r/min	侧面	4把	
副主轴	电主轴/伺服主轴马达功率	7.5kW/4kW	功率	1kW	
	最大夹紧直径	Φ20mm	夹头	ER11/ER16(各2把)	
			可选配端面动力头	3把	
主轴转速	0-5000r/min	可选配副主轴专用端面动力头	4把		
主轴马达功率	2kW	排刀刀具	12*12方刀+Φ20孔刀	6把+4把	

19

Machine model					B20			
Parameters					Configuration			
Power	rated voltage	3 phase AC 380V	Stroke	X1 stroke	500mm (Dia. value)	Name	Model/specification	Origin
	rated frequency	50HZ		Z1 stroke	200mm	System	LNC	TAIWAN
	total input power	17kw		X1 servo motor power	1KW	Spindle	CHINA	Own made
CNC SYSTEM	LNC	LNC-T6800D	Cooling system	Z1 servo motor power	1KW	X axis motor	1 KW absolute servo motor	INOVANCE+BUSLINE
	Minimum setting unit	0.001mm		Cutting motor power	0.18kw	Y axis motor	1 KW absolute servo motor	INOVANCE+BUSLINE
	Minimum moving unit X	0.0005mm		Capacity of coolant container	150L	Z axis motor	1 KW absolute servo motor	INOVANCE+BUSLINE
	Minimum moving unit Z	0.001mm	Lube system	Motor power	25W	Ball screw		YUER,CHINA
	Cutting speed	1--4000mm/min		Capacity	1.5L	Guideway		REXLOTH,GERMANY
	X rapid travel speed	20000mm/min	Live tool	Side live tool	4 nos.			
	Y rapid travel speed	20000mm/min		Power	1KW			
Z rapid travel speed	20000mm/min	ER collet		ER11/ER16(each 2 nos.)				
Spindle	Max. bar through hole	Φ20mm	Live tool	Front live tool (optional)	3 nos.			
	spindel through diameter	Φ21mm		Front live tool for sub spindle(optional)	4 nos.			
	Spindle center height from the ground	1050mm						

	Motorized/Sevrvo spindle revolving speed	10000/5000r/min	Tool post	12*12 squre tool+ ϕ 20 boring tool	6 nos.+4 nos.
	Power of Motorized/Servo spindle	7.5kw/4KW			
Sub spindle	Max. clamping dia.	Φ 20mm			
	Spindle speed	0-5000r/min			
	motor power	2kw			
Stroke					
	X stroke	140mm (Dia. value)			
	Y stroke	300mm			
	Z stroke	300mm			
	X axis servo motor power	1KW			
	Y axis servo motor power	1KW			
	Z axis servo motor power	1KW	Machine size	L*W*H	2090*1200*1800
	Guideway	Linear guideway		Weight	2000kgs

